



Star Performance in Every Respect.

STRENGTH. BEAUTY. EFFICIENCY. DURABILITY.
YOU CAN HAVE IT ALL WITH METALWORKS®



METALWORKS
STEEL SHINGLES **TAMKO**
metalworksroof.com



StoneCrest® Slate Sierra Slate Grey

Contemporary Protection.

MetalWorks® Steel Shingles pair the latest looks with the trusted strength of steel. And whether it's the sleek look of tile, the dramatic look of wood or the classic look of slate, MetalWorks products provide the right shingle for any taste. The shingles are available in a full array of colors, all of which are ENERGY STAR® qualified for certain applications, to provide the ideal choice for a wide range of residential and commercial applications. Visit metalworksroof.com for details.

Built for performance.

G-90 STEEL CONSTRUCTION

Recognized as the industry standard.

KYNAR 500® /HYLAR 5000® FINISH

Resists fading and chalking.

PERFECT FOR REROOFING APPLICATIONS

Can be installed over up to two layers of asphalt shingles.*

BETTER FOR THE ENVIRONMENT

100% recyclable and made from up to 50% recycled material.

50-YEAR LIMITED WARRANTY**

From TAMKO® for your peace of mind.

FOUR-WAY LOCKING SYSTEM

For enhanced performance.

CUSTOM COLOR MATCHING

For a color requirement that does not appear in Standard Colors, please contact TAMKO to inquire about our Special Color Program.

ENERGY STAR® QUALIFIED***

To help enhance energy efficiency.

AstonWood® Forest Green



StoneCrest® Slate Vermont Blue

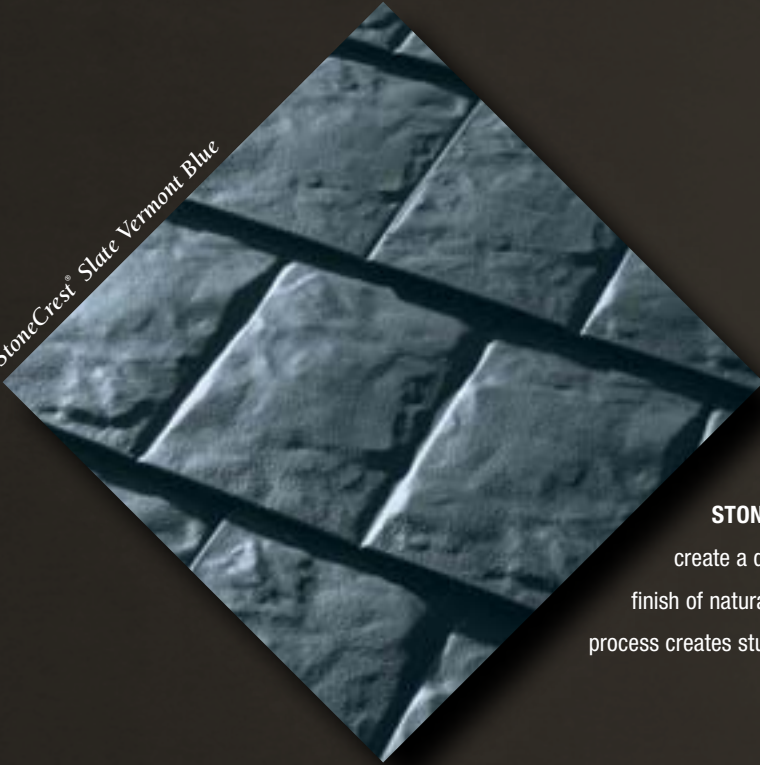

StoneCrest® Tile Vermont Blue



STONECREST® SLATE STEEL SHINGLES

create a dramatic look that closely replicates the random finish of natural slate. The double-stamped manufacturing process creates stunning beauty and durability.

AstonWood® Timber Brown

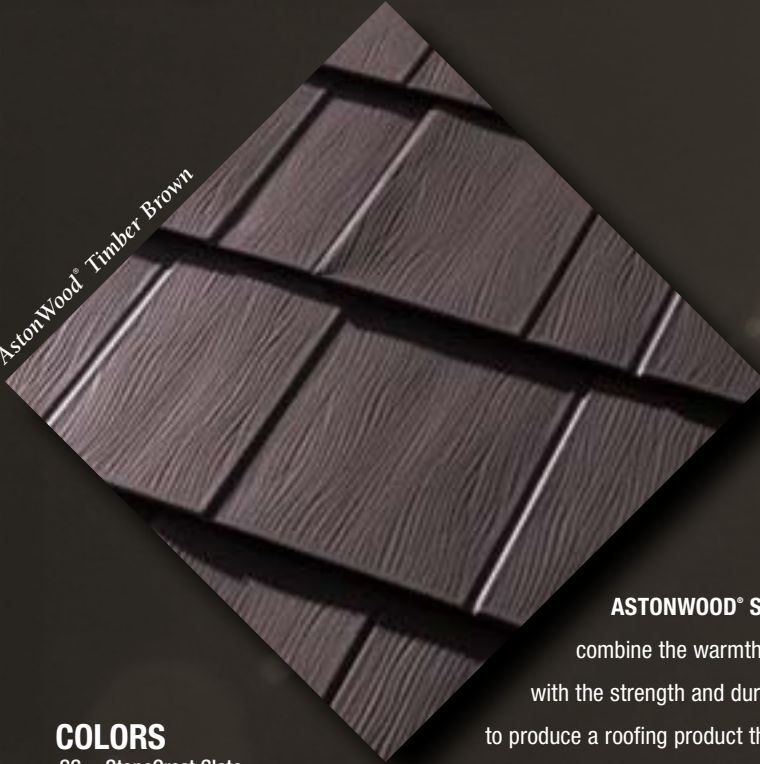

StoneCrest® Slate Vermont Blue



ASTONWOOD® STEEL SHINGLES

combine the warmth and appeal of cedar shingles with the strength and durability of galvanized steel to produce a roofing product that replicates the rich, deep hand-hewn texture of wood.

COLORS

SS = StoneCrest Slate
AW = AstonWood
ST = StoneCrest Tile

SEQUOIA RED
• SS • AW •

SIERRA SLATE GREY
• SS • AW • ST •

VERMONT BLUE
• SS • AW • ST •

FOREST GREEN
• AW •

NOTE: REPRODUCTION OF THESE COLORS IS AS ACCURATE AS OUR PRINTING WILL PERMIT. TAMKO® RECOMMENDS VIEWING AN ACTUAL ROOF INSTALLATION OR SEVERAL FULL-SIZE SHINGLES PRIOR TO FINAL COLOR SELECTION FOR THE FULL IMPACT OF COLOR BLENDING AND PATTERNS.

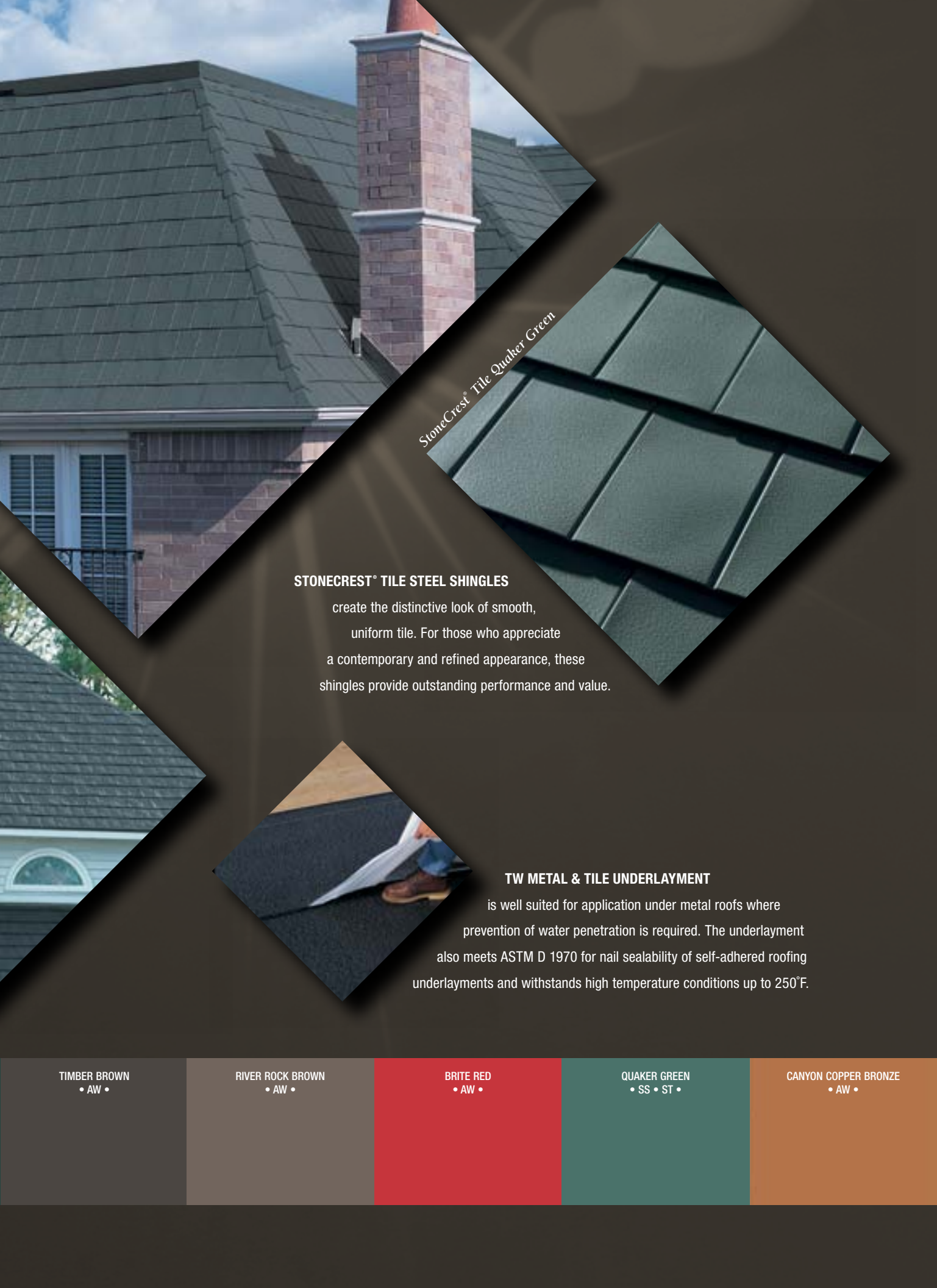

StoneCrest® Tile Quaker Green

STONECREST® TILE STEEL SHINGLES

create the distinctive look of smooth, uniform tile. For those who appreciate a contemporary and refined appearance, these shingles provide outstanding performance and value.

TW METAL & TILE UNDERLAYMENT

is well suited for application under metal roofs where prevention of water penetration is required. The underlayment also meets ASTM D 1970 for nail sealability of self-adhered roofing underlayments and withstands high temperature conditions up to 250°F.

TIMBER BROWN
• AW •

RIVER ROCK BROWN
• AW •

BRITE RED
• AW •

QUAKER GREEN
• SS • ST •

CANYON COPPER BRONZE
• AW •

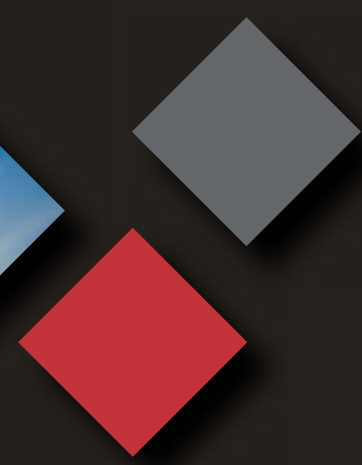

Beautiful. Strong. And now, ENERGY STAR® qualified.

MetalWorks® Steel Shingles have always combined the classic looks of slate, tile and wood with the outstanding strength and protection of metal. Now they offer additional performance attributes that make them more attractive than ever.

All MetalWorks Shingles are now ENERGY STAR® qualified and eligible products to file for the tax credit under the American Recovery and Reinvestment Act (ARRA) of 2009. Before purchasing ENERGY STAR products or other material, contact your tax professional for complete details and to see if you qualify.

MetalWorks Shingles are also rated by the Cool Roof Rating Council (CRRC), delivering the solar reflectance performance that characterizes cool roof products.

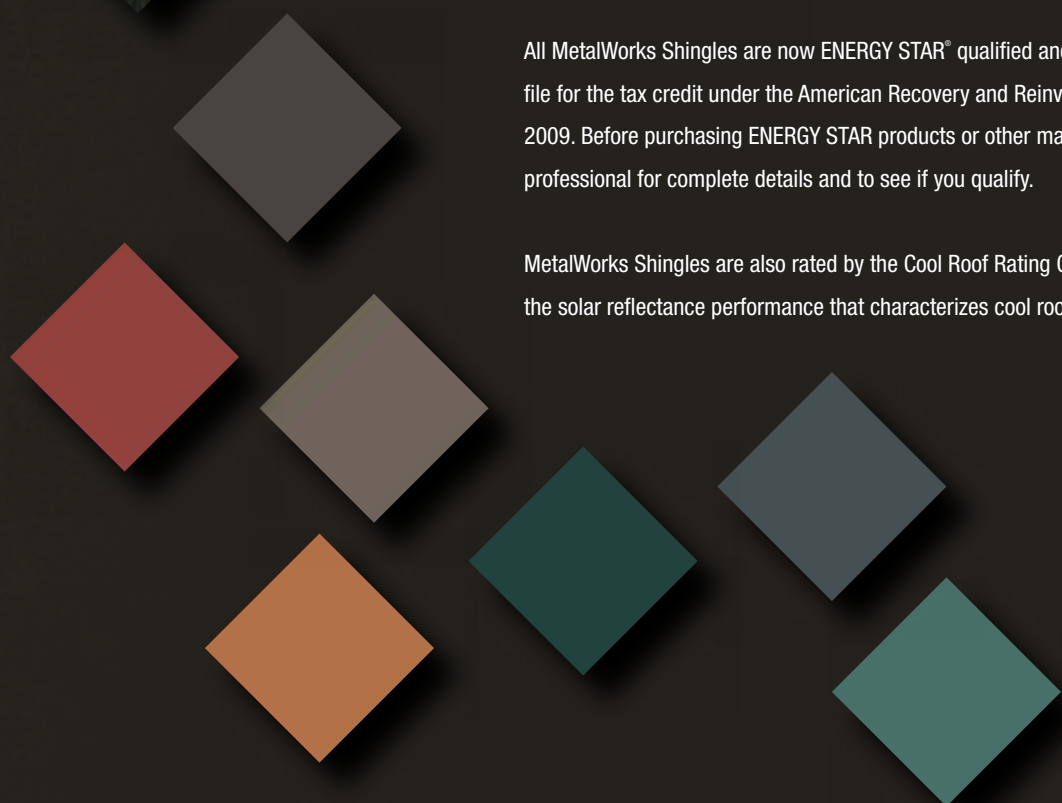

ENERGY STAR is a joint program of the U.S. Environmental Protection Agency and the U.S. Department of Energy. It helps homeowners and businesses save money and protect the environment through energy-efficient products and practices. Qualified roofing products reflect more of the sun's energy back into the atmosphere, keeping the roof cooler.



The Cool Roof Rating Council (CRRC) is an independent nonprofit organization that lists a third-party rating system for the radiative properties of roof surfacing materials. A cool roof has the ability to accomplish two things: 1) reflect the sun's energy (solar reflectance) and 2) quickly give off any heat that it does absorb (thermal emittance). The higher the reflectance and emittance ratings, the more "cool" a product is considered to be. The benefits of a cool roof can include increased indoor comfort, reduced cooling costs™ and help with local code compliance in areas where cool roofing is a requirement.

MetalWorks® Steel Shingles

AstonWood® Steel Shingle

30 pc. per carton/98.4 sq. ft. per carton • 61 lb. per square

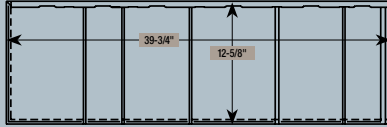

StoneCrest® Slate and StoneCrest® Tile Steel Shingles

15 pc. per carton/49.2 sq. ft. per carton • 74 lb. per square

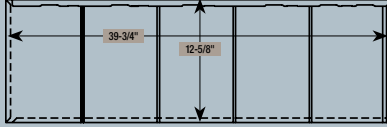

Metal Accessories

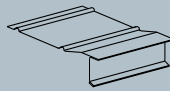

Starter/Eave Flashing
10 pc. per carton/10' length

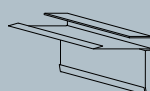

Gable/Rake Flashing
10 pc. per carton/10' length

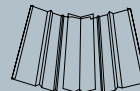

Valley
5 pc. per carton/10' length

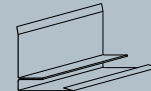

Sidewall Flashing
5 pc. per carton/10' length

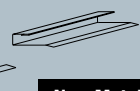

J-Channel
10 pc. per carton/
10' length

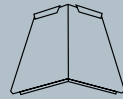

Hip Cap Tapered
StoneCrest or AstonWood
50 pc. per carton/7' length

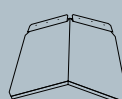

12" Ridge Cap
25 pc. per carton/
1' length



Trim Coil
22-1/4" x 50"



Clip
400 per carton/
100+/- per square



Snow Guard
100 pc. per carton



Colored Screws
0.5-lb. bag of 50 pc.

Non-Metal Accessories

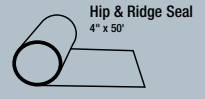

Hip & Ridge Seal
4" x 50'



Touch-up Paint
2-oz. bottle

STONECREST SLATE

- Painted Galvanized Steel
- Minimum slope: 3" in 12"
- Shingle width—overall: 39-3/4"
- Shingle height—overall: 12-5/8"
- Shingle exposure: 12"
- Shingles per box: 15 panels
- Coverage per box: 49.2 sq. ft. (Approx. 1/2 square)
- Weight per shingle: 2.5 lb.
- Weight per square: 74 lb.

- Shingle Material: Nominal 0.0162" (0.066802 cm) thickness, including G-90 galvanization and paint coatings. Exterior finish is fluoropolymer (PVDF) with anticorrosive primer, 1 mil dry film thickness. Interior finish is a wash coat with anticorrosive primer, 0.6 mil dry film thickness
- Clip: 1-1/4" wide x 2-1/8" long x 0.20" deep
- Clip Material: 0.015" thick, G-90 galvanized steel

ASTONWOOD

- Painted Galvanized Steel
- Minimum slope: 3" in 12"
- Shingle width—overall: 39-3/4"
- Shingle height—overall: 12-5/8"
- Shingle exposure: 12"
- Shingles per box: 30 panels
- Coverage per box: 98.4 sq. ft. (Approx. 1 square)
- Weight per shingle: 2 lb.
- Weight per square: 61 lb.

- Shingle Material: Nominal 0.0135" (0.03429 cm) thickness, including G-90 galvanization and paint coatings. Exterior finish is fluoropolymer (PVDF) with anticorrosive primer, 1 mil dry film thickness. Interior finish is a wash coat with anticorrosive primer, 0.6 mil dry film thickness
- Clip: 1-1/4" wide x 2-1/8" long x 0.20" deep
- Clip Material: 0.015" thick, G-90 galvanized steel

STONECREST TILE

- Painted Galvanized Steel
- Minimum slope: 3" in 12"
- Shingle width—overall: 39-3/4"
- Shingle height—overall: 12-5/8"
- Shingle exposure: 12"
- Shingles per box: 15 panels
- Coverage per box: 49.2 sq. ft. (Approx. 1/2 square)
- Weight per shingle: 2.5 lb.
- Weight per square: 74 lb.

- Shingle Material: Nominal 0.0162" (0.066802 cm) thickness, including G-90 galvanization and paint coatings. Exterior finish is fluoropolymer (PVDF) with anticorrosive primer, 1 mil dry film thickness. Interior finish is a wash coat with anticorrosive primer, 0.6 mil dry film thickness
- Clip: 1-1/4" wide x 2-1/8" long x 0.20" deep
- Clip Material: 0.015" thick, G-90 galvanized steel

Building Products for the Professional

Information included in this brochure was current at the time of printing. To obtain a copy of the most current version of this brochure, visit us online at tamko.com or call us at 1-800-641-4691.

* Check your local building code. Building code restrictions may apply.

** To obtain a copy of TAMKO's Limited Warranty, visit us online at tamko.com or call us at 1-800-641-4691.

*** Reduction in energy consumption and cooling cost savings, if any, will vary depending on the individual structure to which the material is applied.

©2010 TAMKO Building Products, Inc.
TAMKO, MetalWorks, StoneCrest and AstonWood are registered trademarks of TAMKO Building Products, Inc.
Kynar 500 is a registered trademark of Arkema, Inc.
Hylar 5000 is a registered trademark of Solvay Solexis, Inc.

TAMKO
BUILDING PRODUCTS

P.O. Box 1404 • Joplin, MO 64802
1-800-641-4691
tamko.com

